

REV-6POL/F400-30kW B/G

FIRE-RATED SWITCH



Code	162547
-------------	--------

	100A, IP65, 2NO, switch 0/1, black/ grey
--	--

Product description

Switch disconnecter 6 poles 100A + 2 early break auxiliary contacts. Fire rated class F400 according to EN 12101-3. Enclosure 2AC in grey color RAL7035 with surface finish treatment to resist corrosion, size 200x200x135. Protection degree IP65. 2 top incomings and 2 bottom outgoing M40. Four fixing points. Black/grey padlockable handle (up to 4 padlocks with 8mm diameter). Operation 90°, padlockable in all positions. Connection with cage terminals for cable 16-35 mm².

Technical data

Thermal rating (Ith)	100 A
Wire section flexible	16 - 50 mm ²
Tightening torque	3,5 Nm
Connection screws	M8
Terminal	
Max. fuse protection (gG/aM)	100/100 A (415 V) 100/100 A (500 V)
Conditional shortcircuit current (Icc)	8 kA (415 V) 8 kA (500 V)
Insulating voltage (V~)	690
Insulating voltage (V...)	600
Operational rating (Ie)	100
Dummy AC-21A	30 kW (3x230 V) 55 kW (3x415 V) 75 kW (3x500 V)
Mixed load AC-22A	30 kW (3x230 V) 55 kW (3x415 V) 55 kW (3x500 V)

Motor load AC-23A	18,5 kW (3x230 V)
	30 kW (3x415 V)
	37 kW (3x500 V)
<hr/>	
Standards	IEC 60947-3
	EN 12101-3

Dimensions

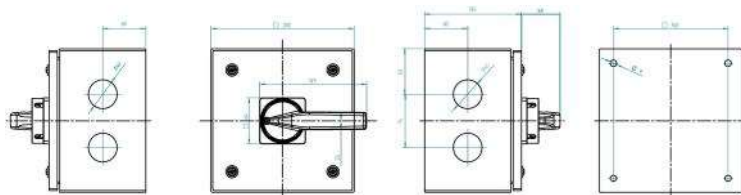

Connection

