

SWK

FRICO



## Fan cooler for effective temperature reduction

SWK is a fan cooler for environments where cool indoor air is required. SWK is suitable for use in shops, warehouses and other environments where cooling is needed. It is available with EC motor, protection class IP54 or with AC motor, protection class IP44. The EC motor enables stepless control of the air flow.

### Comfortable cooling

SWK delivers comfortable cooling without compromising on sound level. Low sound level and adjustable fan speed provide optimum conditions for a pleasant indoor environment.

### Efficient operation

The SWK fan cooler provides rapid and efficient cooling at low cost. SWK is an excellent choice when considering making use of free cooling.

### Easy installation

The SWK fan cooler is mounted on the wall with the supplied brackets. Smart design facilitates maintenance and makes installation easy. SWK is intended for water connection.



### Product specifications

- Designed for cooling operation
- Hydrophilic-coated aluminium fins for better drainage.
- Insulated drip tray in stainless steel.
- 4 mm fin spacing minimises the risk of dust and dirt clogging up water coil.
- Supplied with air director with individually adjustable louvres that direct the air flow on one plane.
- Wall brackets included.

Design and specifications are subject to change without notice.

## Fan cooler SWK, EC motor (IP54)

Art. no	Type	Cooling output (total)* <sup>1</sup> [kW]	Cooling output (sensible)* <sup>1</sup> [kW]	Airflow [m <sup>3</sup> /h]	Sound power* <sup>2</sup> [dB(A)]	Sound pressure* <sup>3</sup> [dB(A)]	Air throw [m]	Water volume* <sup>4</sup> [l]	Voltage [V]	Amperage [A]	Weight [kg]
449522	SWKEC12	6,6	5,1	2000	68	51	8	3,0	230V~	0,55	51
449523	SWKEC22	11,5	8,9	3500	78	59	8	5,1	230V~	1,35	66

## Fan cooler SWK, AC motor (IP44)

Art. no	Type	Cooling output (total)* <sup>1</sup> [kW]	Cooling output (sensible)* <sup>1</sup> [kW]	Airflow [m <sup>3</sup> /h]	Sound power* <sup>2</sup> [dB(A)]	Sound pressure* <sup>3</sup> [dB(A)]	Air throw [m]	Water volume* <sup>4</sup> [l]	Voltage [V]	Amperage [A]	Weight [kg]
414653	SWK12	6,6	5,1	2000	68	52	8	3,0	230V~	0,6	50
414654	SWK22	11,5	8,9	3500	78	62	8	5,1	230V~	0,95	65

\*<sup>1</sup>) Applies at water temperature +6/12 °C, air temperature in +25 °C, relative humidity 50 %.

\*<sup>2</sup>) Sound power ( $L_{WA}$ ).

\*<sup>3</sup>) Sound pressure ( $L_{pA}$ ). Conditions: Distance to the unit 5 metres.

\*<sup>4</sup>) Water volume inside water coil.

Intended for water temperatures from 0 °C up to +150 °C and 16 bar.  
Max. surrounding temperature +40 °C.

Manufactured in Sweden with a corrosion proof housing made of hot zinc-plate and powder coated steel panels. Colour: white, RAL 9016.

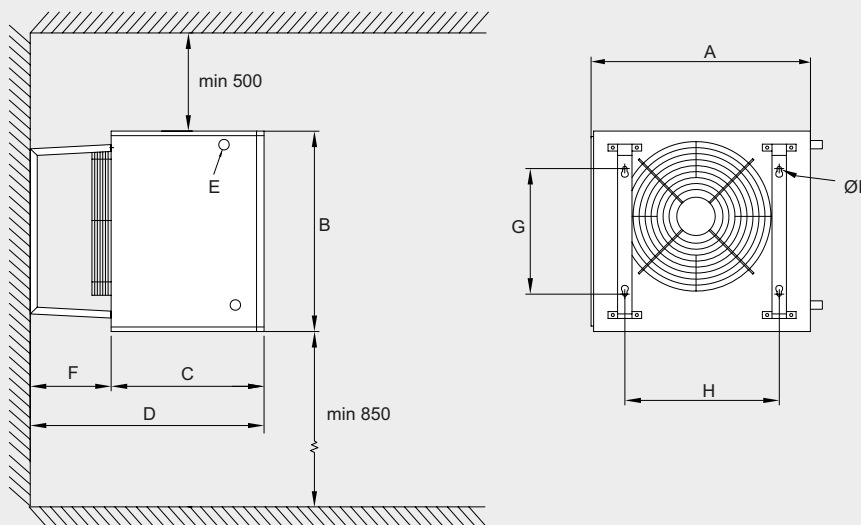

	A [mm]	B [mm]	C [mm]	D [mm]	E [mm]	F [mm]	G [mm]	H [mm]	ØI [mm]
SWKEC/SWK12	730	670	510	780	28	270	420	515	10
SWKEC/SWK22	920	875	510	780	28	270	550	700	10

**SWK**

## Mounting

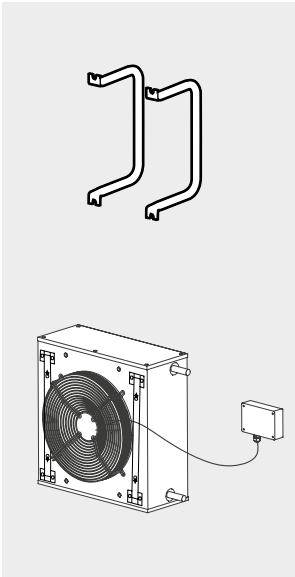

### Mounting and connection

#### Mounting

The fan cooler is for wall mounting with mounting brackets provided. For minimum distance, see dimension diagrams.

#### Connection of the coil

The fan cooler is supplied with tube connections on the left-hand side. The water coil has copper tubes with smooth pipe connections, for press-fitting or clamp ring coupling. The condensate drain has a G1/2" connection. An air valve should be connected at a high point in the pipe system. Vent- and drain valves are not included. Pipes and valves must be insulated.

#### Connection

The fan motor is connected to a detached terminal box, which is mounted on a wall next to the unit.

For mounting, output charts, wiring diagrams and other technical information, please see the manual and [www.frico.net](http://www.frico.net).

## Accessories



### SDB, extra air director

To direct the air stream sideways. On delivery, the fan cooler is equipped with an air director for vertical direction of the air stream.

Item number	Type	Used for	HxWxD [mm]
414655	<b>SDB12</b>	SWKEC12, SWK12	675X654X82
414656	<b>SDB22</b>	SWKEC22, SWK22	880X784X82

## Control options



### SWKEC - Stepless airflow control

The FCR230 regulates the airflow according to the set room temperature.

Complete regulation kit:

- FCR230, room regulator
- VPTK, VPTK\_NC or VOT\_NC, valve kit

### SWK - Control by thermostat

The thermostat starts/stops the fan and also controls the heat supply on/off.

Complete regulation kit:

- KRT1900, KRTV19 or TKS16, room thermostat
- TVVS20/25, 2-way valve or TRVS20/25 3-way valve + SD20, actuator



**SWKEC**

**FCR230, room regulator**

FCR230 is a room regulator for control of heating and/or cooling in a room. It is intended to control 230V thermic actuators and has fan control that regulates the fan speed steplessly with an analogue 0-10V signal. Communication via Modbus, BACnet or EXOline. The regulator has an integrated sensor, alternatively an external room sensor (ECG1) can be connected.

**VPTK, valve kit**

Valve kit with two-way valve and 230V actuator. Normally closed. Available in four models: DN15 Kvs 0.4 or 0.6 and DN20 Kvs 2.4 or 4.0.

**VPTK\_NC, pressure independent valve system on/off**

Two way pressure independent control and adjustment valve with on/off actuator and shut-off valve. Normally closed. DN15/20/25/32. 230V.

**VOT\_NC, three-way valve kit**

Valve kit with three-way valve and 230V actuator. Normally closed. DN15/20/25.

**SWK**



**TKS16, thermostat**

Processor controlled thermostat with visible dials and 1-pole main switch. Setting range +5 – +30 °C. Alternating contact for heating or cooling. Connection voltage: 230V. Max. breaking current: 16 A. IP30.

**KRT1900/KRTV19, capillary tube thermostats**

Capillary tube thermostat with concealed (KRT1900) or visible knob (KRTV19). Setting range 0 – +40 °C. Max. breaking current: 16/10 A (230/400V). IP55 (KRT1900) or IP44 (KRTV19).

**TVVS20/25, valves + SD20, actuator**

TVVS20/25, 2-way regulation valve and SD20, actuator on/off provides a basic form of water regulation, without the possibility of adjusting or shutting the water flow off, e.g. when making maintenance. A suitable thermostat is chosen to regulate TVVS20/25 and SD20. DN20/25.

**TRVS20/25, 3-way control valve**

If a 3-way valve is preferred, TRVS20/25 can be used instead of TVVS20/25.

Item number	Type	Dimensions
76649	<b>FCR230</b>	120x102x29 mm
11929	<b>ECG1</b>	86x86x30 mm
157457	<b>VPTK1504</b>	DN15 Kvs 0,4
157458	<b>VPTK1506</b>	DN15 Kvs 0,6
157459	<b>VPTK2025</b>	DN20 Kvs 2,5
157460	<b>VPTK2040</b>	DN20 Kvs 4,0
456586	<b>VPTK15NFNC</b>	DN15
456587	<b>VPTK15LFNC</b>	DN15
398214	<b>VPTK20NC</b>	DN20
398215	<b>VPTK25NC</b>	DN25
454159	<b>VPTK32NC</b>	DN32
457399	<b>VOT15NC</b>	DN15
457400	<b>VOT20NC</b>	DN20
457401	<b>VOT25NC</b>	DN25

Item number	Type	Dimensions
11651	<b>TKS16</b>	80x80x39 mm
5999	<b>KRT1900</b>	165x57x60 mm
10214	<b>KRTV19</b>	165x57x60 mm
24729	<b>TVVS20</b>	DN20
24730	<b>TVVS25</b>	DN25
19019	<b>TRVS20</b>	DN20
19020	<b>TRVS25</b>	DN25
10073	<b>SD20</b>	230V