

## Safety

### Safety definitions

Warnings, cautions and notes are used to point out specially important parts of the manual.



**Warning**

If you do not obey these instructions, there is a risk of death or injury.



**Caution**

If you do not obey these instructions, there is a risk of damage to the product, other materials or the adjacent area.

#### Note:

Information that is necessary in a given situation.

### Safety instructions



**Warning**

Read the warning instructions that follow before you start the dismantling.

- Before you do work on the product, disconnect the power supply and wait until the product stops.
- Only permit approved personnel to work on the product and to be in the adjacent area during all work on the product.

- Use applicable safety devices and personal protective equipment during all work on the product.
- Obey local conditions and laws for recycling.

### Personal protective equipment

Use personal protective equipment during all work on the product.

- Approved eye protection
- Approved protective helmet
- Approved hearing protection
- Approved protective gloves
- Approved protective shoes
- Approved work clothing

### Tools required

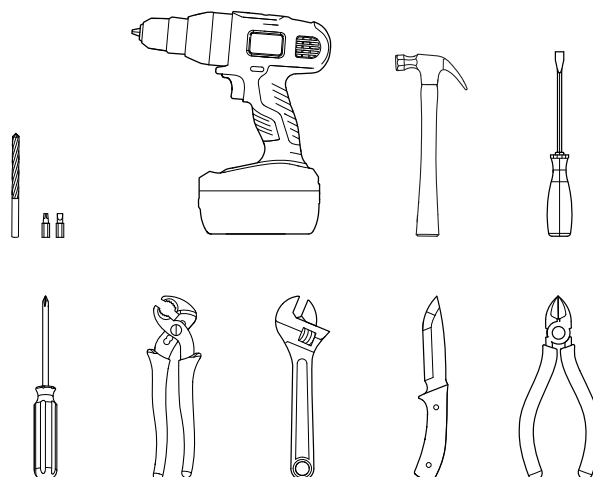

## Removal of parts



**Warning**

Be careful during removal of the material. Parts of the material can be heavy and have sharp edges. There is risk of injury to persons.

- Remove all plastic parts.
- Remove door handles, hinges and if in use, circuit breaker.
- Remove insulation — Use a knife to remove the insulation.
- Remove filter, motors and heat exchanger — To remove the motors and the heat exchangers, disconnect the fast couplings to the electrical wires. Pull out the filters, motors and heat exchangers. Refer to the Installation, operation and maintenance manual for your product.
- Remove the electrical connection box. If necessary remove the rivets with a drill.
- Removal of the steel sheet.

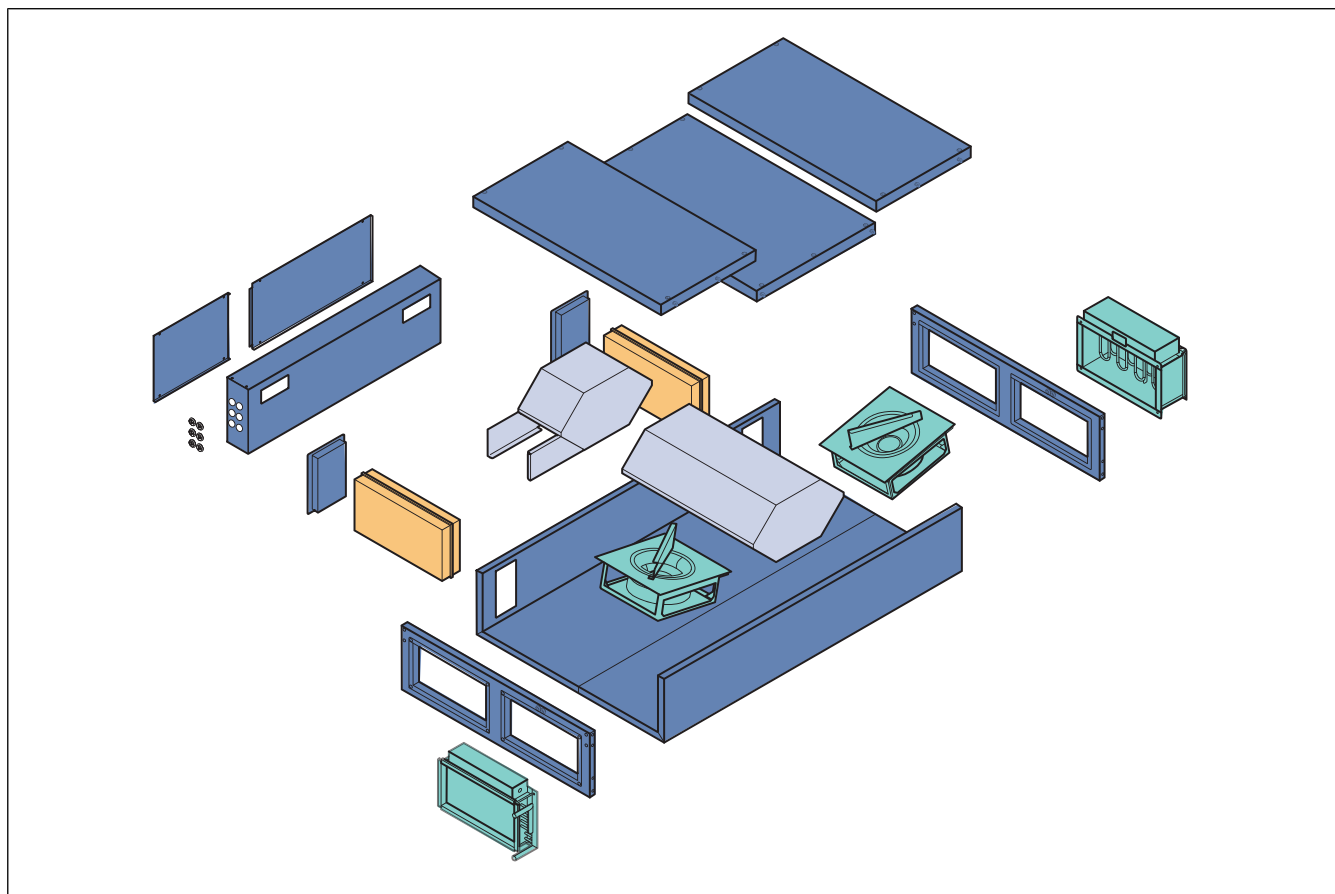

Plastic



Steel sheet



Exchanger, bypass damper



Fans, heaters



Filter

## Recycling

- Make sure that the material is recycled. Observe national regulations.
- The product and the transport packaging are largely made of recyclable raw materials.
- Disassemble the product into its components.
- Separate the parts according to:
  - reusable material
  - material groups to be disposed of (metal, plastics, electrical parts)